

# Submitting Documents for Academic Initial Eligibility

## United Kingdom

### PURPOSE

To participate at an NCAA Division I or II school, you must be certified as academically eligible by working with your secondary school to have them submit your academic documents to the Eligibility Center. This resource is designed to help you understand how and when to submit specific documents (e.g., General Certificate of Secondary Education exam results) that will give you a faster and more accurate academic decision. *Questions about this resource?* Email the Eligibility Center at [ec-international@ncaa.org](mailto:ec-international@ncaa.org) or use the [International Contact Form](#).

### WHAT EXAMS OR CREDENTIALS HAVE YOU COMPLETED OR EARNED?

Have you taken any GCSE exams?

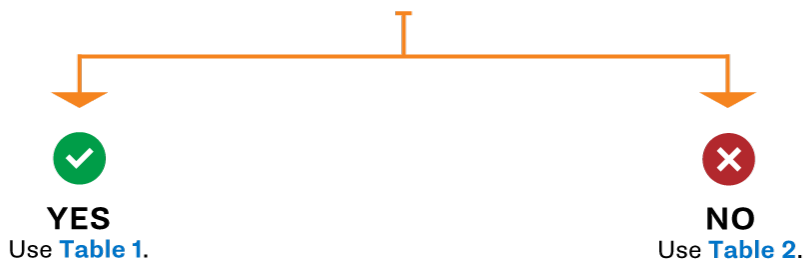

AND/OR

Have you taken any other exams or earned any other certificates (e.g., A-Levels, AS Exams, BTEC, GCE O-Level, OCR Level 1 or 2, WJEC Level 1/2)?

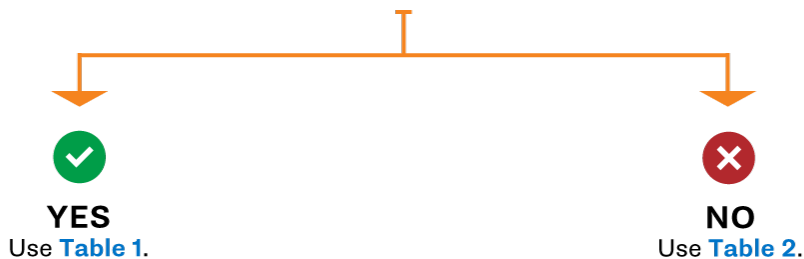

**Note:** You are not permitted to send any academic records to the Eligibility Center. Ensure your secondary school has your board-issued exam results or certificates.

# TABLE 1

Are your board-issued GCSE exam certificates or results available?

**Note:** Board-issued GCSE exam certificates are commonly provided as paper copies.

**AND/OR**

Are any of your other board-issued exam certificates or results available (e.g., A-Levels, AS Exams, BTEC, GCE O-Level, OCR Level 1 or 2, WJEC Level 1/2)?

**Note:** School-issued exam certificates or results cannot be submitted to the Eligibility Center for use in your academic certification.

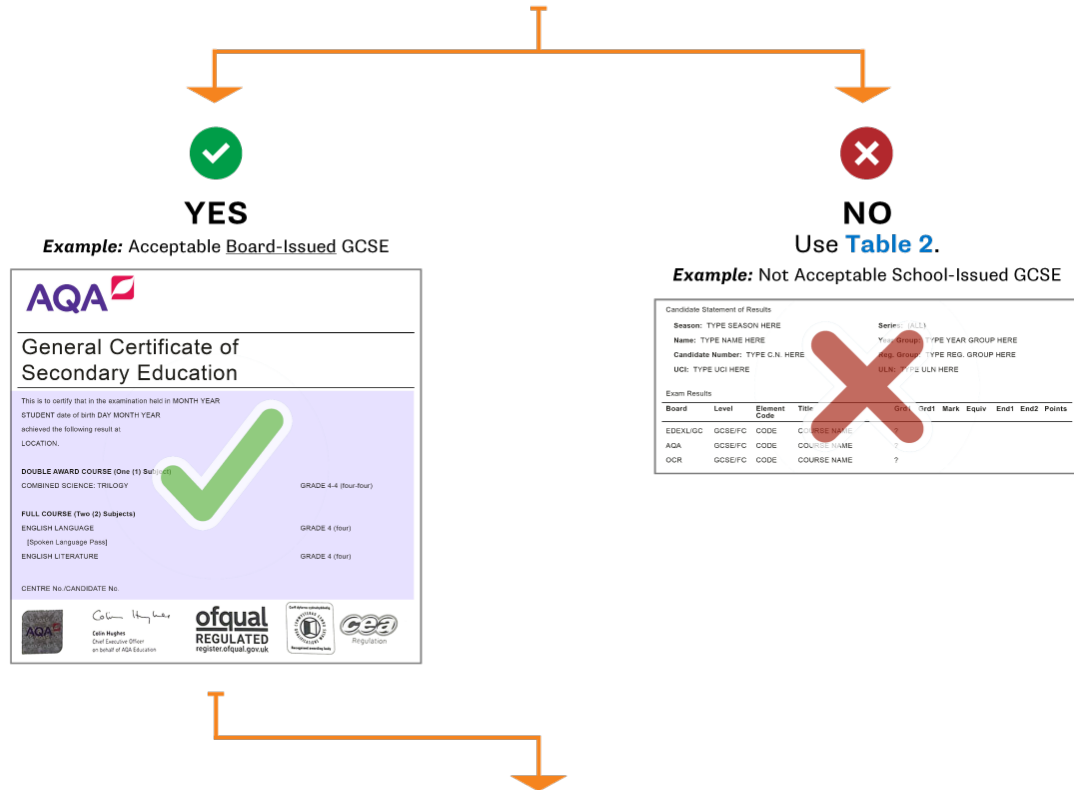

**Note:** You are not permitted to send any academic records to the Eligibility Center. Ensure your secondary school has your board-issued exam results or certificates.

1. Download the [United Kingdom Academic Record Submission Checklist](#) and email the checklist to your secondary school.
2. Ensure your secondary school has your board-issued exam certificates or results.  
**Note:** Only your secondary school can submit these academic records to the Eligibility Center.
3. In addition to the GCSE exams, if you have taken or are in the process of taking any other exams or attempting to earn any other certificates, reference the [Graduation Timeline Confirmation Form](#).  
**Examples:** A-Levels, AS Exams, BTEC, GCE O-Level, OCR Level 1 or 2, WJEC Level 1/2.

# TABLE 2

Review this table, if you answered “No” in the [introduction questions](#) or [Table 1](#).

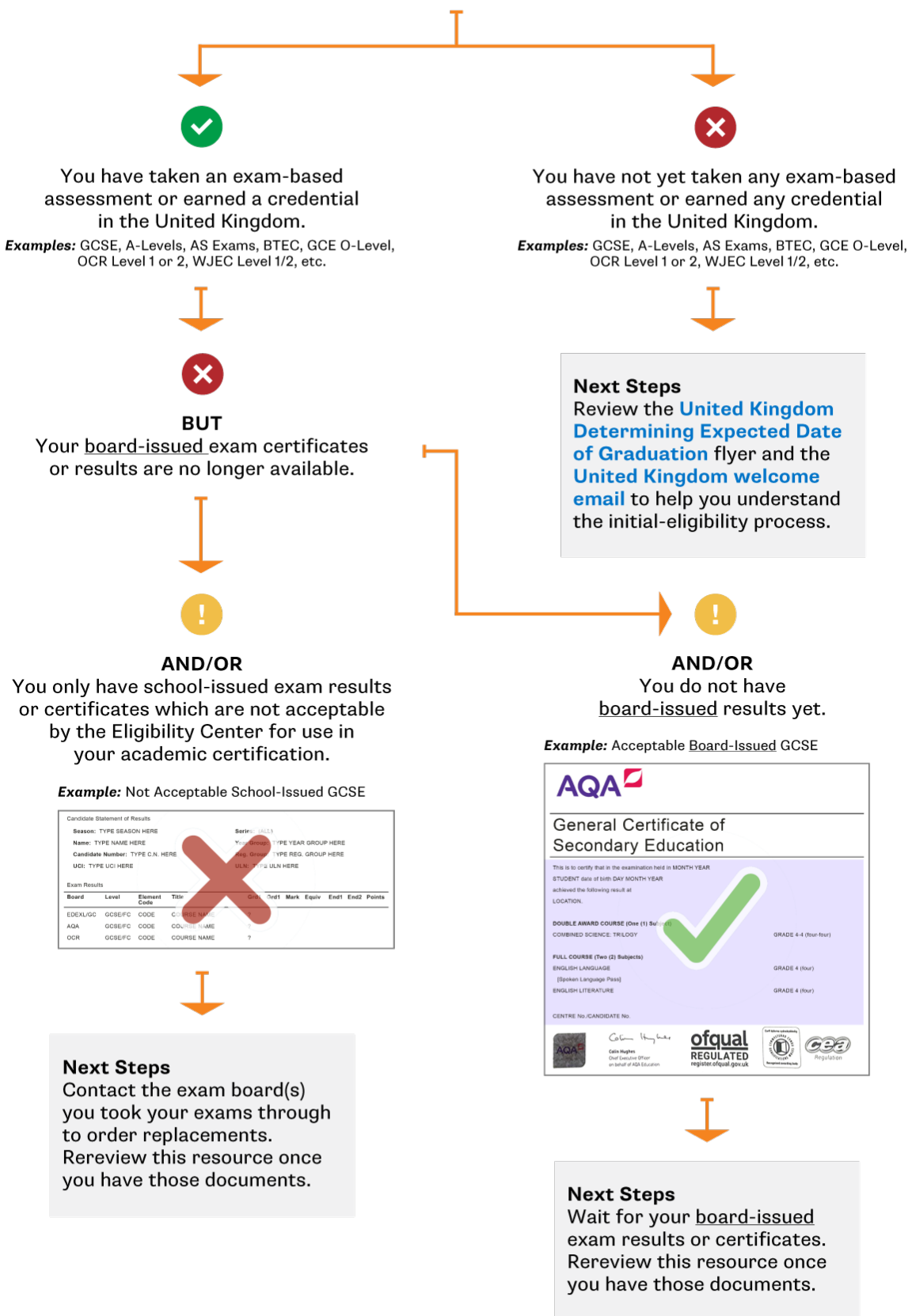

**Note:** During your certification review, additional academic documents may be requested (e.g., secondary school transcripts) that are not listed in this resource.